

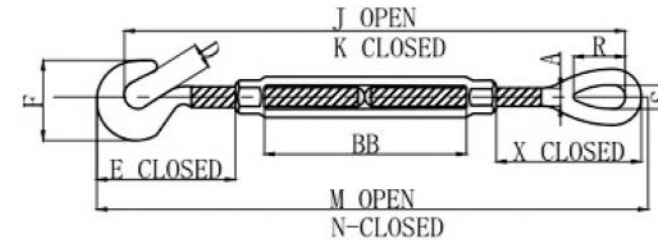

US TYPE TURNBUCKLE WITH HOOK & EYE



- STANDARD:US STANDARD
- MATERIAL:45# CARBON STEEL
- TECHNOLOGY:DROP FORGED
- SURFACE FINISH:ELECTO GALVANIZED,HOT DIP GALVANIZED
- ULTIMATE LOAD:5 TIMES OF THE WLL

TURNBUCKLE

| Size (in) | WLL (lbs) | Weight (lbs) | Dimensions(in) | | | | | | | | | | | |
|--------------|--------------|-----------------|----------------|------|-------------|------|-----------|-------------|-----------|-------------|------|------|-------------|-------|
| | | | A | D | E Closed | F | J Open | K Closed | M Open | N Closed | R | S | X Closed | BB |
| 1/4*4 | 400 | 0.30 | 0.25 | 0.45 | 1.59 | 1.27 | 11.46 | 7.46 | 12.09 | 8.09 | 0.78 | 0.34 | 1.75 | 4.00 |
| 5/16*4-1/2 | 700 | 0.47 | 0.31 | 0.50 | 1.94 | 1.50 | 13.19 | 8.69 | 13.47 | 9.47 | 0.94 | 0.44 | 2.09 | 4.50 |
| 3/8*6 | 1000 | 0.75 | 0.38 | 0.56 | 2.30 | 1.77 | 16.50 | 10.98 | 17.94 | 11.94 | 1.12 | 0.53 | 2.52 | 6.00 |
| 1/2*6 | 1500 | 1.60 | 0.50 | 0.66 | 2.94 | 2.28 | 18.45 | 12.45 | 19.67 | 13.16 | 1.44 | 0.72 | 3.23 | 6.00 |
| 1/2*9 | 1500 | 1.83 | 0.50 | 0.66 | 2.94 | 2.28 | 24.45 | 15.45 | 25.67 | 16.67 | 1.44 | 0.72 | 3.23 | 9.00 |
| 1/2*12 | 1500 | 2.08 | 0.50 | 0.66 | 2.94 | 2.28 | 30.45 | 18.45 | 31.67 | 19.67 | 1.44 | 0.72 | 3.23 | 12.00 |
| 5/8*6 | 2250 | 2.75 | 0.63 | 0.84 | 3.69 | 2.81 | 19.96 | 13.96 | 21.47 | 15.47 | 1.75 | 0.88 | 3.90 | 6.00 |
| 5/8*9 | 2250 | 3.13 | 0.63 | 0.84 | 3.69 | 2.81 | 25.96 | 16.96 | 27.47 | 18.47 | 1.75 | 0.88 | 3.90 | 9.00 |
| 5/8*12 | 2250 | 3.50 | 0.63 | 0.84 | 3.69 | 2.81 | 31.96 | 19.96 | 33.47 | 21.47 | 1.75 | 0.88 | 3.90 | 12.00 |
| 3/4*6 | 3000 | 3.89 | 0.75 | 0.98 | 4.52 | 3.33 | 21.63 | 25.96 | 23.45 | 17.45 | 2.09 | 1.00 | 4.69 | 6.00 |
| 3/4*9 | 3000 | 4.16 | 0.75 | 0.98 | 4.52 | 3.33 | 27.63 | 31.96 | 29.45 | 20.45 | 2.09 | 1.00 | 4.69 | 9.00 |
| 3/4*12 | 3000 | 5.43 | 0.75 | 0.98 | 4.52 | 3.33 | 33.63 | 21.63 | 35.45 | 23.45 | 2.09 | 1.00 | 4.69 | 12.00 |
| 3/4*18 | 3000 | 7.25 | 0.75 | 0.98 | 4.52 | 3.33 | 45.63 | 27.63 | 47.45 | 29.45 | 2.09 | 1.00 | 4.69 | 18.00 |
| 7/8*12 | 4000 | 8.10 | 0.88 | 1.13 | 5.19 | 3.78 | 34.78 | 22.78 | 36.91 | 24.91 | 2.38 | 1.25 | 5.10 | 12.00 |
| 7/8*18 | 4000 | 9.95 | 0.88 | 1.13 | 5.19 | 3.78 | 46.78 | 28.78 | 48.91 | 30.91 | 2.38 | 1.25 | 5.10 | 18.00 |
| 1*6 | 5000 | 9.33 | 1.00 | 1.25 | 5.84 | 4.25 | 24.80 | 18.80 | 27.20 | 21.2 | 3.00 | 1.44 | 6.36 | 6.00 |
| 1*12 | 5000 | 11.93 | 1.00 | 1.25 | 5.84 | 4.25 | 36.80 | 24.80 | 39.20 | 27.2 | 3.00 | 1.44 | 6.36 | 12.00 |
| 1*18 | 5000 | 14.00 | 1.00 | 1.25 | 5.84 | 4.25 | 48.80 | 30.80 | 51.20 | 33.2 | 3.00 | 1.44 | 6.36 | 18.00 |
| 1*24 | 5000 | 17.25 | 1.00 | 1.25 | 5.84 | 4.25 | 60.80 | 36.80 | 63.20 | 39.2 | 3.00 | 1.44 | 6.36 | 24.00 |
| 1-1/4*12 | 5000 | 19.00 | 1.25 | 1.50 | 7.22 | 5.13 | 39.13 | 27.13 | 42.06 | 30.06 | 3.56 | 1.81 | 7.72 | 12.00 |
| 1-1/4*18 | 5000 | 23.00 | 1.25 | 1.50 | 7.22 | 5.13 | 51.13 | 33.13 | 54.06 | 36.06 | 3.56 | 1.81 | 7.72 | 18.00 |
| 1-1/4*24 | 5000 | 27.00 | 1.25 | 1.50 | 7.22 | 5.13 | 63.13 | 39.13 | 66.06 | 42.06 | 3.56 | 1.81 | 7.72 | 24.00 |
| 1-1/2*12 | 7500 | 27.50 | 1.50 | 1.88 | 8.34 | 5.75 | 41.72 | 29.72 | 44.72 | 32.72 | 4.06 | 2.12 | 8.62 | 12.00 |
| 1-1/2*18 | 7500 | 31.00 | 1.50 | 1.88 | 8.34 | 5.75 | 53.72 | 35.72 | 56.72 | 38.72 | 4.06 | 2.12 | 8.62 | 18.00 |
| 1-1/2*24 | 7500 | 37.50 | 1.50 | 1.88 | 8.34 | 5.75 | 65.72 | 41.72 | 68.72 | 44.72 | 4.06 | 2.12 | 8.62 | 24.00 |

US TYPE TURNBUCKLE WITH HOOK & HOOK

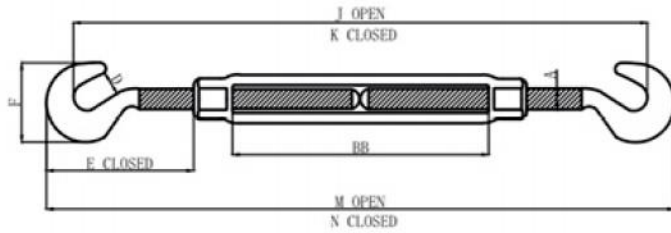

- STANDARD:US STANDARD
- MATERIAL:45# CARBON STEEL
- TECHNOLOGY:DROP FORGED
- SURFACE FINISH:ELECTO GALVANIZED,HOT DIP GALVANIZED
- ULTIMATE LOAD:5 TIMES OF THE WLL

US TYPE TURNBUCKLE WITH EYE & EYE

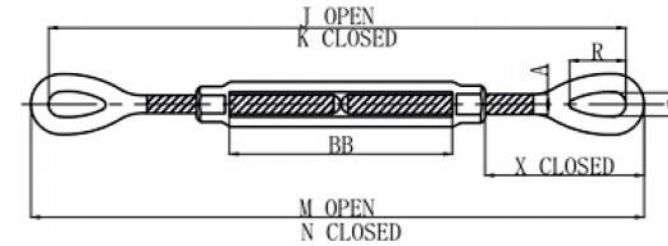

- STANDARD:US STANDARD
- MATERIAL:45# CARBON STEEL
- TECHNOLOGY:DROP FORGED
- SURFACE FINISH:ELECTO GALVANIZED,HOT DIP GALVANIZED
- ULTIMATE LOAD:5 TIMES OF THE WLL

| Size (in) | WLL (lbs) | Weight (lbs) | Dimensions(in) | | | | | | | | |
|--------------|--------------|-----------------|----------------|-------------|-----------|-------------|-----------|-------------|------|------|-------|
| | | | A | E Closed | J Open | K Closed | M Open | N Closed | D | F | BB |
| 1/4*4 | 400 | 0.33 | 0.25 | 1.59 | 11.12 | 7.12 | 11.94 | 7.94 | 0.45 | 1.27 | 4.00 |
| 5/16*4 1/2 | 700 | 0.52 | 0.31 | 1.94 | 12.81 | 8.31 | 13.81 | 9.31 | 0.50 | 1.50 | 4.50 |
| 3/8*6 | 1000 | 0.83 | 0.38 | 2.30 | 16.50 | 10.50 | 17.72 | 11.72 | 0.56 | 1.77 | 6.00 |
| 1/2*6 | 1500 | 1.88 | 0.50 | 2.94 | 18.82 | 11.82 | 20.38 | 13.38 | 0.66 | 2.28 | 6.00 |
| 1/2*12 | 1500 | 2.77 | 0.50 | 2.94 | 30.82 | 17.82 | 32.38 | 19.38 | 0.66 | 2.28 | 12.00 |
| 5/8*6 | 2250 | 3.21 | 0.63 | 3.69 | 20.50 | 13.25 | 22.50 | 15.25 | 0.90 | 2.81 | 6.00 |
| 5/8*12 | 2250 | 4.58 | 0.63 | 3.69 | 32.50 | 19.25 | 34.50 | 21.25 | 0.90 | 2.81 | 12.00 |
| 3/4*6 | 3000 | 4.20 | 0.75 | 4.52 | 22.38 | 14.88 | 24.78 | 17.28 | 0.98 | 3.33 | 6.00 |
| 3/4*12 | 3000 | 6.92 | 0.75 | 4.52 | 34.38 | 20.88 | 36.78 | 23.28 | 0.98 | 3.33 | 12.00 |
| 3/4*18 | 3000 | 8.65 | 0.75 | 4.52 | 46.38 | 26.88 | 48.78 | 29.28 | 0.98 | 3.33 | 18.00 |
| 7/8*12 | 4000 | 9.85 | 0.88 | 5.19 | 36.00 | 22.25 | 38.75 | 25.00 | 1.13 | 3.78 | 12.00 |
| 1*12 | 5000 | 11.93 | 1.00 | 5.84 | 37.63 | 23.63 | 40.69 | 26.69 | 1.25 | 4.25 | 12.00 |
| 1*18 | 5000 | 14.00 | 1.00 | 5.84 | 49.63 | 29.63 | 52.69 | 32.69 | 1.25 | 4.25 | 18.00 |
| 1*24 | 5000 | 17.25 | 1.00 | 5.84 | 61.63 | 35.63 | 64.69 | 38.69 | 1.25 | 4.25 | 24.00 |
| 1 1/4*12 | 6500 | 20.58 | 1.25 | 7.22 | 40.44 | 25.94 | 44.06 | 29.56 | 1.50 | 5.13 | 12.00 |
| 1 1/4*18 | 6500 | 23.00 | 1.25 | 7.22 | 52.44 | 31.94 | 56.06 | 35.56 | 1.50 | 5.13 | 18.00 |
| 1 1/4*24 | 6500 | 27.00 | 1.25 | 7.22 | 64.44 | 37.94 | 68.06 | 41.56 | 1.50 | 5.13 | 24.00 |
| 1 1/2*12 | 7500 | 27.50 | 1.50 | 8.34 | 43.94 | 28.94 | 47.44 | 32.44 | 1.88 | 5.75 | 12.00 |
| 1 1/2*18 | 7500 | 31.00 | 1.50 | 8.34 | 55.96 | 34.94 | 59.44 | 38.44 | 1.88 | 5.75 | 18.00 |
| 1 1/2*24 | 7500 | 37.50 | 1.50 | 8.34 | 67.94 | 40.94 | 71.44 | 44.44 | 1.88 | 5.75 | 24.00 |

| Size (in) | WLL (lbs) | Weight (lbs) | Dimensions(in) | | | | | | | | |
|--------------|--------------|-----------------|----------------|-----------|-------------|-----------|-------------|------|------|-------------|-------|
| | | | A | J Open | K Closed | M Open | N Closed | R | S | X Closed | BB |
| 1/4*4 | 500 | 0.30 | 0.25 | 11.80 | 7.80 | 12.25 | 8.25 | 0.78 | 0.34 | 1.75 | 4.00 |
| 5/16*4-1/2 | 800 | 0.47 | 0.31 | 13.56 | 9.06 | 14.12 | 9.62 | 0.94 | 0.44 | 2.09 | 4.50 |
| 3/8*6 | 1200 | 0.75 | 0.38 | 17.47 | 11.47 | 18.16 | 12.16 | 1.12 | 0.53 | 2.52 | 6.00 |
| 1/2*6 | 2200 | 1.60 | 0.50 | 19.08 | 13.08 | 19.96 | 13.96 | 1.44 | 0.72 | 3.23 | 6.00 |
| 1/2*9 | 2200 | 1.83 | 0.50 | 25.08 | 16.08 | 25.96 | 16.96 | 1.44 | 0.72 | 3.23 | 9.00 |
| 1/2*12 | 2200 | 2.08 | 0.50 | 31.08 | 19.08 | 31.96 | 19.96 | 1.44 | 0.72 | 3.23 | 12.00 |
| 5/8*6 | 3500 | 2.75 | 0.63 | 20.68 | 14.68 | 21.68 | 15.68 | 1.75 | 0.88 | 3.90 | 6.00 |
| 5/8*9 | 3500 | 3.13 | 0.63 | 26.68 | 17.68 | 27.68 | 18.68 | 1.75 | 0.88 | 3.90 | 9.00 |
| 5/8*12 | 3500 | 3.50 | 0.63 | 32.68 | 20.68 | 33.68 | 21.68 | 1.75 | 0.88 | 3.90 | 12.00 |
| 3/4*6 | 5200 | 3.89 | 0.75 | 22.38 | 16.38 | 23.62 | 17.62 | 2.09 | 1.00 | 4.69 | 6.00 |
| 3/4*9 | 5200 | 4.61 | 0.75 | 28.38 | 19.38 | 29.62 | 20.62 | 2.09 | 1.00 | 4.69 | 9.00 |
| 3/4*12 | 5200 | 5.43 | 0.75 | 34.38 | 22.38 | 35.62 | 23.62 | 2.09 | 1.00 | 4.69 | 12.00 |
| 3/4*18 | 5200 | 7.25 | 0.75 | 46.38 | 28.38 | 47.62 | 29.62 | 2.09 | 1.00 | 4.69 | 18.00 |
| 7/8*12 | 7200 | 8.10 | 0.88 | 35.32 | 23.32 | 36.82 | 24.82 | 2.38 | 1.25 | 5.10 | 12.00 |
| 7/8*18 | 7200 | 9.95 | 0.88 | 47.32 | 29.32 | 48.82 | 30.82 | 2.38 | 1.25 | 5.10 | 18.00 |
| 1*6 | 10000 | 9.33 | 1.00 | 25.97 | 19.97 | 27.72 | 21.72 | 3.00 | 1.44 | 6.36 | 6.00 |
| 1*12 | 10000 | 11.93 | 1.00 | 37.97 | 25.97 | 39.97 | 27.72 | 3.00 | 1.44 | 6.36 | 12.00 |
| 1*18 | 10000 | 14.00 | 1.00 | 49.97 | 31.97 | 51.72 | 33.72 | 3.00 | 1.44 | 6.36 | 18.00 |
| 1*24 | 10000 | 17.25 | 1.00 | 61.97 | 37.97 | 63.72 | 39.72 | 3.00 | 1.44 | 6.36 | 24.00 |
| 1-1/4*12 | 15200 | 19.00 | 1.25 | 40.31 | 28.31 | 42.56 | 30.56 | 3.56 | 1.81 | 7.72 | 12.00 |
| 1-1/4*18 | 15200 | 23.00 | 1.25 | 52.31 | 34.31 | 54.56 | 36.56 | 3.56 | 1.81 | 7.72 | 18.00 |
| 1-1/4*24 | 15200 | 27.00 | 1.25 | 64.31 | 40.31 | 66.56 | 42.56 | 3.56 | 1.81 | 7.72 | 24.00 |
| 1-1/2*12 | 21400 | 27.50 | 1.50 | 42.50 | 30.50 | 45.00 | 33.00 | 4.06 | 2.12 | 8.62 | 12.00 |
| 1-1/2*18 | 21400 | 31.00 | 1.50 | 54.50 | 36.50 | 57.00 | 39.00 | 4.06 | 2.12 | 8.62 | 18.00 |
| 1-1/2*24 | 21400 | 37.50 | 1.50 | 66.50 | 42.50 | 69.00 | 45.00 | 4.06 | 2.12 | 8.62 | 24.00 |
| 1-3/4*18 | 28000 | 52.50 | 1.75 | 57.38 | 39.38 | 60.38 | 42.38 | 4.62 | 2.38 | 10.00 | 18.00 |
| 1-3/4*24 | 28000 | 58.00 | 1.75 | 69.38 | 45.38 | 72.38 | 48.38 | 4.62 | 2.38 | 10.00 | 24.00 |
| 2*24 | 37000 | 85.25 | 2.00 | 75.69 | 51.69 | 79.19 | 55.19 | 5.75 | 2.69 | 13.09 | 24.00 |
| 2-1/2*24 | 60000 | 144.25 | 2.50 | 78.62 | 54.62 | 82.62 | 58.62 | 6.50 | 3.12 | 13.78 | 24.00 |
| 2-3/4*24 | 75000 | 194.00 | 2.75 | 81.00 | 57.00 | 85.50 | 61.50 | 7.00 | 3.25 | 15.22 | 24.00 |

US TYPE TURNBUCKLE WITH EYE & JAW

US TYPE TURNBUCKLE WITH JAW & JAW

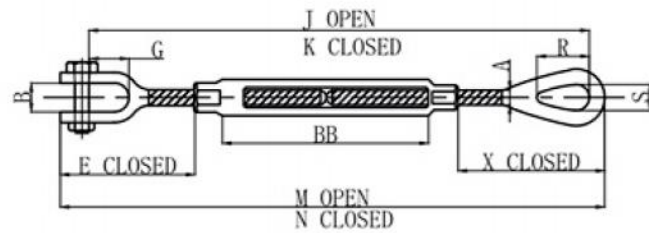

- STANDARD:US STANDARD
- MATERIAL:45# CARBON STEEL
- TECHNOLOGY:DROP FORGED
- SURFACE FINISH:ELECTO GALVANIZED,HOT DIP GALVANIZED
- ULTIMATE LOAD:5 TIMES OF THE WLL

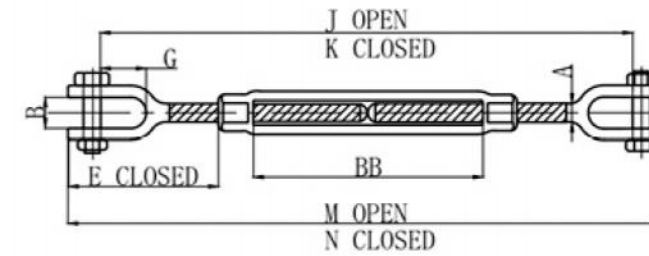

- STANDARD:US STANDARD
- MATERIAL:45# CARBON STEEL
- TECHNOLOGY:DROP FORGED
- SURFACE FINISH:ELECTO GALVANIZED,HOT DIP GALVANIZED
- ULTIMATE LOAD:5 TIMES OF THE WLL

| Size (in) | Working Load Limit (lbs) | Weight (lbs) | Dimensions(in) | | | | | | | | | | | |
|--------------|-----------------------------------|-----------------|----------------|------|-------------|------|-----------|-------------|-----------|-------------|------|------|-------------|-------|
| | | | A | B | E Closed | G | J Open | K Closed | M Open | N Closed | R | S | X Closed | BB |
| 1/4*4 | 500 | 0.32 | 0.25 | 0.41 | 1.58 | 0.62 | 11.35 | 7.35 | 2.07 | 8.07 | 0.78 | 0.34 | 1.75 | 4.00 |
| 5/16*4 1/2 | 800 | 0.47 | 0.31 | 0.47 | 1.98 | 0.87 | 13.71 | 8.71 | 14.01 | 9.51 | 0.94 | 0.44 | 2.09 | 4.50 |
| 3/8*6 | 1200 | 0.76 | 0.38 | 0.50 | 2.12 | 0.87 | 16.81 | 10.81 | 17.77 | 11.77 | 1.12 | 0.53 | 2.52 | 6.00 |
| 1/2*6 | 2200 | 1.53 | 0.50 | 0.63 | 2.75 | 1.06 | 18.29 | 12.28 | 19.48 | 13.48 | 1.44 | 0.72 | 3.23 | 6.00 |
| 1/2*9 | 2200 | 1.71 | 0.50 | 0.63 | 2.75 | 1.06 | 24.29 | 15.29 | 25.48 | 16.48 | 1.44 | 0.72 | 3.23 | 9.00 |
| 1/2*12 | 2200 | 2.06 | 0.50 | 0.63 | 2.75 | 1.06 | 30.29 | 18.29 | 31.48 | 19.48 | 1.44 | 0.72 | 3.23 | 12.00 |
| 5/8*6 | 3500 | 2.35 | 0.63 | 0.75 | 3.50 | 1.31 | 19.74 | 13.74 | 21.28 | 15.28 | 1.75 | 0.88 | 3.90 | 6.00 |
| 5/8*9 | 3500 | 3.06 | 0.63 | 0.75 | 3.50 | 1.31 | 25.74 | 16.74 | 27.28 | 18.28 | 1.75 | 0.88 | 3.90 | 9.00 |
| 5/8*12 | 3500 | 3.78 | 0.63 | 0.75 | 3.50 | 1.31 | 31.74 | 19.74 | 33.28 | 21.28 | 1.75 | 0.88 | 3.90 | 12.00 |
| 3/4*6 | 5200 | 4.00 | 0.75 | 0.94 | 4.18 | 1.50 | 21.19 | 15.19 | 23.11 | 17.11 | 2.09 | 1.00 | 4.69 | 6.00 |
| 3/4*9 | 5200 | 4.75 | 0.75 | 0.94 | 4.18 | 1.50 | 27.19 | 18.19 | 29.11 | 20.11 | 2.09 | 1.00 | 4.69 | 9.00 |
| 3/4*12 | 5200 | 5.36 | 0.75 | 0.94 | 4.18 | 1.50 | 33.19 | 21.19 | 35.11 | 23.11 | 2.09 | 1.00 | 4.69 | 12.00 |
| 3/4*18 | 5200 | 7.00 | 0.75 | 0.94 | 4.18 | 1.50 | 45.19 | 27.19 | 47.11 | 29.11 | 2.09 | 1.00 | 4.69 | 18.00 |
| 7/8*12 | 7200 | 8.00 | 0.88 | 1.13 | 4.85 | 1.75 | 34.34 | 23.34 | 36.57 | 24.57 | 2.38 | 1.25 | 5.10 | 12.00 |
| 7/8*18 | 7200 | 9.75 | 0.88 | 1.13 | 4.85 | 1.75 | 46.34 | 28.34 | 48.57 | 30.57 | 2.38 | 1.25 | 5.10 | 18.00 |
| 1*6 | 10000 | 8.92 | 1.00 | 1.19 | 5.53 | 2.06 | 24.34 | 18.34 | 26.89 | 20.89 | 3.00 | 1.44 | 6.36 | 6.00 |
| 1*12 | 10000 | 11.20 | 1.00 | 1.19 | 5.53 | 2.06 | 36.34 | 24.34 | 38.89 | 26.89 | 3.00 | 1.44 | 6.36 | 12.00 |
| 1*18 | 10000 | 13.30 | 1.00 | 1.19 | 5.53 | 2.06 | 48.34 | 30.34 | 50.89 | 32.89 | 3.00 | 1.44 | 6.36 | 18.00 |
| 1*24 | 10000 | 17.00 | 1.00 | 1.19 | 5.53 | 2.06 | 60.34 | 36.34 | 62.89 | 38.89 | 3.00 | 1.44 | 6.36 | 24.00 |
| 1 1/4*12 | 15200 | 20.00 | 1.25 | 1.75 | 7.21 | 2.81 | 38.82 | 26.82 | 42.05 | 30.05 | 3.56 | 1.81 | 7.72 | 12.00 |
| 1 1/4*18 | 15200 | 24.18 | 1.25 | 1.75 | 7.21 | 2.81 | 50.82 | 32.82 | 54.05 | 36.05 | 3.56 | 1.81 | 7.72 | 18.00 |
| 1 1/4*24 | 15200 | 28.50 | 1.25 | 1.75 | 7.21 | 2.81 | 62.82 | 38.82 | 66.05 | 42.05 | 3.56 | 1.81 | 7.72 | 24.00 |
| 1 1/2*12 | 21400 | 28.99 | 1.50 | 2.06 | 7.88 | 2.81 | 40.50 | 28.50 | 44.25 | 32.25 | 4.06 | 2.12 | 8.62 | 12.00 |
| 1 1/2*18 | 21400 | 35.00 | 1.50 | 2.06 | 7.88 | 2.81 | 52.50 | 34.50 | 56.25 | 38.25 | 4.06 | 2.12 | 8.62 | 18.00 |
| 1 1/2*24 | 21400 | 39.18 | 1.50 | 2.06 | 7.88 | 2.81 | 64.50 | 40.50 | 68.25 | 44.25 | 4.06 | 2.12 | 8.62 | 24.00 |
| 1 3/4*18 | 28000 | 53.75 | 1.75 | 2.38 | 9.40 | 3.38 | 55.38 | 37.38 | 59.78 | 41.78 | 4.62 | 2.38 | 10.00 | 18.00 |
| 1 3/4*24 | 28000 | 60.68 | 1.75 | 2.38 | 9.40 | 3.38 | 67.38 | 43.38 | 71.78 | 47.78 | 4.62 | 2.38 | 10.00 | 24.00 |
| 2 * 24 | 37000 | 89.00 | 2.00 | 2.50 | 11.86 | 3.69 | 72.62 | 48.62 | 77.95 | 53.95 | 5.75 | 2.69 | 13.09 | 24.00 |
| 2 1/2 * 24 | 60000 | 150.00 | 2.50 | 2.88 | 13.56 | 4.44 | 75.80 | 51.80 | 82.40 | 58.40 | 6.50 | 3.12 | 13.78 | 24.00 |
| 2 3/4 * 24 | 75000 | 183.00 | 2.75 | 2.50 | 15.22 | 4.19 | 77.88 | 53.88 | 85.50 | 61.50 | 7.00 | 3.25 | 15.22 | 24.00 |

| Size (in) | Working Load Limit (lbs) | Weight (lbs) | Dimensions(in) | | | | | | | | |
|--------------|-----------------------------------|-----------------|----------------|------|-------------|------|-----------|-------------|-----------|-------------|-------|
| | | | A | B | E Closed | G | J Open | K Closed | M Open | N Closed | BB |
| 1/4*4 | 500 | 0.36 | 0.25 | 0.41 | 1.58 | 0.62 | 10.90 | 6.90 | 11.90 | 7.90 | 4.00 |
| 5/16*4 1/2 | 800 | 0.52 | 0.31 | 0.47 | 1.98 | 0.87 | 12.36 | 8.36 | 13.90 | 9.40 | 4.50 |
| 3/8*6 | 1200 | 0.81 | 0.38 | 0.50 | 2.12 | 0.87 | 16.14 | 10.14 | 17.38 | 11.38 | 6.00 |
| 1/2*6 | 2200 | 1.50 | 0.50 | 0.63 | 2.75 | 1.06 | 17.50 | 11.50 | 19.00 | 13.00 | 6.00 |
| 1/2*9 | 2200 | 1.74 | 0.50 | 0.63 | 2.75 | 1.06 | 23.50 | 14.50 | 25.00 | 16.00 | 9.00 |
| 1/2*12 | 2200 | 2.46 | 0.50 | 0.63 | 2.75 | 1.06 | 29.50 | 17.50 | 31.00 | 19.00 | 12.00 |
| 5/8*6 | 3500 | 2.72 | 0.63 | 0.75 | 3.50 | 1.31 | 18.80 | 12.80 | 20.88 | 14.88 | 6.00 |
| 5/8*9 | 3500 | 3.24 | 0.63 | 0.75 | 3.50 | 1.31 | 24.80 | 15.80 | 26.88 | 17.88 | 9.00 |
| 5/8*12 | 3500 | 3.74 | 0.63 | 0.75 | 3.50 | 1.31 | 30.80 | 18.80 | 32.88 | 20.88 | 12.00 |
| 3/4*6 | 5200 | 4.11 | 0.75 | 0.94 | 4.18 | 1.50 | 20.00 | 14.00 | 22.60 | 16.60 | 6.00 |
| 3/4*9 | 5200 | 5.10 | 0.75 | 0.94 | 4.18 | 1.50 | 26.00 | 17.00 | 28.60 | 19.60 | 9.00 |
| 3/4*12 | 5200 | 5.65 | 0.75 | 0.94 | 4.18 | 1.50 | 32.00 | 20.00 | 34.60 | 22.60 | 12.00 |
| 3/4*18 | 5200 | 7.00 | 0.75 | 0.94 | 4.18 | 1.50 | 44.00 | 26.00 | 46.60 | 28.60 | 18.00 |
| 7/8*12 | 7200 | 8.17 | 0.88 | 1.13 | 4.85 | 1.75 | 33.36 | 21.36 | 36.32 | 24.32 | 12.00 |
| 7/8*18 | 7200 | 9.96 | 0.88 | 1.13 | 4.85 | 1.75 | 43.36 | 27.36 | 48.32 | 30.32 | 18.00 |
| 1*6 | 10000 | 8.56 | 1.00 | 1.19 | 5.53 | 2.06 | 22.72 | 16.72 | 26.06 | 20.06 | 6.00 |
| 1*12 | 10000 | 12.00 | 1.00 | 1.19 | 5.53 | 2.06 | 34.72 | 22.72 | 38.06 | 26.06 | 12.00 |
| 1*18 | 10000 | 14.00 | 1.00 | 1.19 | 5.53 | 2.06 | 46.72 | 28.72 | 50.06 | 32.06 | 18.00 |
| 1*24 | 10000 | 17.00 | 1.00 | 1.19 | 5.53 | 2.06 | 58.72 | 34.72 | 62.06 | 38.06 | 24.00 |
| 1-1/4*12 | 15200 | 21.50 | 1.25 | 1.75 | 7.21 | 2.81 | 37.34 | 25.34 | 41.54 | 29.54 | 12.00 |
| 1-1/4*18 | 15200 | 24.25 | 1.25 | 1.75 | 7.21 | 2.81 | 49.34 | 31.34 | 53.54 | 35.54 | 18.00 |
| 1-1/4*24 | 15200 | 28.00 | 1.25 | 1.75 | 7.21 | 2.81 | 61.34 | 37.34 | 65.54 | 41.54 | 24.00 |
| 1-1/2*12 | 21400 | 30.50 | 1.50 | 2.06 | 7.88 | 2.81 | 38.50 | 26.50 | 43.50 | 31.50 | 12.00 |
| 1-1/2*18 | 21400 | 36.75 | 1.50 | 2.06 | 7.88 | 2.81 | 50.50 | 32.50 | 55.50 | 37.50 | 18.00 |
| 1-1/2*24 | 21400 | 40.67 | 1.50 | 2.06 | 7.88 | 2.81 | 62.50 | 38.50 | 67.50 | 43.50 | 24.00 |
| 1-3/4*18 | 28000 | 55.04 | 1.75 | 2.38 | 9.40 | 3.38 | 53.38 | 35.38 | 59.18 | 41.18 | 18.00 |
| 1-3/4*24 | 28000 | 63.36 | 1.75 | 2.38 | 9.40 | 3.38 | 65.38 | 41.38 | 71.18 | 47.18 | 24.00 |
| 2*24 | 37000 | 94.25 | 2.00 | 2.50 | 11.86 | 3.69 | 69.54 | 45.54 | 76.72 | 52.12 | 24.00 |
| 2-1/2*24 | 60000 | 165.00 | 2.50 | 2.88 | 13.56 | 4.44 | 72.98 | 48.98 | 82.18 | 58.18 | 24.00 |
| 2-3/4*24 | 75000 | 198.00 | 2.75 | 2.50 | 15.22 | 4.19 | 74.75 | 50.75 | 85.50 | 61.50 | 24.00 |

US TYPE TURNBUCKLE BODY

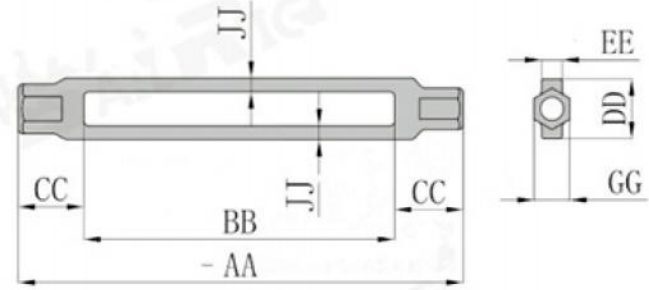

- STANDARD:US STANDARD
- MATERIAL:45# CARBON STEEL
- TECHNOLOGY:DROP FORGED
- SURFACE FINISH:ELECTO GALVANIZED,HOT DIP GALVANIZED
- ULTIMATE LOAD:5 TIMES OF THE WLL

JIS TYPE FRAME TURNBUCKLE

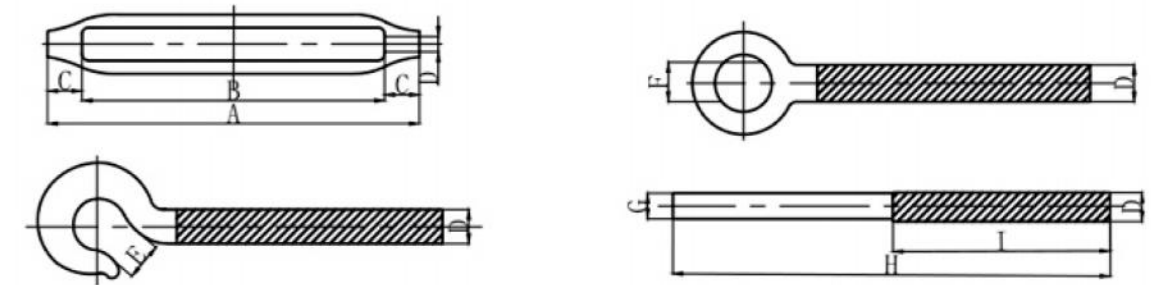

- STANDARD:JIS STANDARD
- MATERIAL:Q235 CARBON STEEL
- TECHNOLOGY:FREE FORGED
- SURFACE FINISH:ELECTO GALVANIZED

| Size (in) | WLL (lbs) | Weight (lbs) | Dimensions(in) | | | | | | | |
|------------|-----------|--------------|----------------|-------|------|------|------|------|------|------|
| | | | AA | BB | CC | DD | EE | GG | HH | JJ |
| 1/4*4 | 500 | 0.15 | 4.75 | 4.00 | 0.38 | 0.72 | 0.34 | 0.50 | 0.38 | 0.71 |
| 5/16*4 1/2 | 800 | 0.19 | 5.44 | 4.50 | 0.47 | 0.81 | 0.38 | 0.56 | 0.44 | 0.19 |
| 3/8*6 | 1200 | 0.29 | 7.12 | 6.00 | 0.56 | 0.88 | 0.38 | 0.62 | 0.50 | 0.19 |
| 1/2*6 | 2200 | 0.60 | 7.50 | 6.00 | 0.75 | 1.12 | 0.50 | 0.81 | 0.62 | 0.25 |
| 1/2*9 | 2200 | 0.68 | 10.50 | 9.00 | 0.75 | 1.12 | 0.50 | 0.81 | 0.62 | 0.25 |
| 1/2*12 | 2200 | 1.00 | 13.50 | 12.00 | 0.75 | 1.12 | 0.50 | 0.81 | 0.62 | 0.25 |
| 5/8*6 | 3500 | 0.90 | 7.88 | 6.00 | 0.94 | 1.38 | 0.62 | 1.00 | 0.75 | 0.31 |
| 5/8*9 | 3500 | 1.18 | 10.88 | 9.00 | 0.94 | 1.38 | 0.62 | 1.00 | 0.75 | 0.31 |
| 5/8*12 | 3500 | 1.43 | 13.88 | 12.00 | 0.94 | 1.38 | 0.62 | 1.00 | 0.75 | 0.31 |
| 3/4*6 | 5200 | 1.30 | 8.25 | 6.00 | 1.12 | 1.69 | 0.75 | 1.12 | 0.94 | 0.38 |
| 3/4*9 | 5200 | 1.75 | 11.25 | 9.00 | 1.12 | 1.69 | 0.75 | 1.12 | 0.94 | 0.38 |
| 3/4*12 | 5200 | 2.08 | 14.25 | 12.00 | 1.12 | 1.69 | 0.75 | 1.12 | 0.94 | 0.38 |
| 3/4*18 | 5200 | 2.50 | 20.25 | 18.00 | 1.12 | 1.69 | 0.75 | 1.12 | 0.94 | 0.38 |
| 7/8*12 | 7200 | 2.70 | 14.62 | 12.00 | 1.31 | 1.94 | 0.88 | 1.31 | 1.06 | 0.44 |
| 7/8*18 | 7200 | 3.80 | 20.62 | 18.00 | 1.31 | 1.94 | 0.88 | 1.31 | 1.06 | 0.44 |
| 1*6 | 10000 | 2.48 | 9.00 | 6.00 | 1.50 | 2.25 | 1.00 | 1.50 | 1.25 | 0.50 |
| 1*12 | 10000 | 3.93 | 15.00 | 12.00 | 1.50 | 2.25 | 1.00 | 1.50 | 1.25 | 0.50 |
| 1*18 | 10000 | 5.28 | 21.00 | 18.00 | 1.50 | 2.25 | 1.00 | 1.50 | 1.25 | 0.50 |
| 1*24 | 10000 | 7.38 | 27.00 | 24.00 | 1.50 | 2.25 | 1.00 | 1.50 | 1.25 | 0.50 |
| 1 1/4*12 | 15200 | 5.25 | 15.12 | 12.00 | 1.56 | 2.62 | 1.25 | 1.88 | 1.50 | 0.56 |
| 1 1/4*18 | 15200 | 7.75 | 21.12 | 18.00 | 1.56 | 2.62 | 1.25 | 1.88 | 1.50 | 0.56 |
| 1 1/4*24 | 15200 | 10.17 | 27.12 | 24.00 | 1.56 | 2.62 | 1.25 | 1.88 | 1.50 | 0.56 |
| 1 1/2*12 | 21400 | 8.75 | 15.75 | 12.00 | 1.88 | 3.00 | 1.50 | 2.25 | 1.75 | 0.62 |
| 1 1/2*18 | 21400 | 11.00 | 21.75 | 18.00 | 1.88 | 3.00 | 1.50 | 2.25 | 1.75 | 0.62 |
| 1 1/2*24 | 21400 | 13.69 | 27.75 | 24.00 | 1.88 | 3.00 | 1.50 | 2.25 | 1.75 | 0.62 |
| 1 3/4*18 | 28000 | 16.38 | 22.38 | 18.00 | 2.09 | 3.62 | 1.75 | 2.62 | 2.12 | 0.75 |
| 1 3/4*24 | 28000 | 21.25 | 28.38 | 24.00 | 2.19 | 3.62 | 1.75 | 2.62 | 2.12 | 0.75 |
| 2*24 | 37000 | 27.60 | 29.00 | 24.00 | 2.50 | 4.12 | 2.00 | 3.00 | 2.38 | 0.88 |
| 2 1/2*24 | 60000 | 54.00 | 31.06 | 24.00 | 3.53 | 5.62 | 2.75 | 3.88 | 3.12 | 1.25 |
| 2 3/4*24 | 75000 | 54.00 | 31.06 | 24.00 | 3.53 | 5.62 | 2.75 | 3.88 | 3.12 | 1.25 |

| Size (D) | | Body Only | | | | | | Eye&Eye | | | Hook&Eye | | | Hook&Hook | | | With Stubs | | | |
|----------|-------|-----------|----|--------|-------|-------|-------|---------|-------|-------|----------|-------|-------|-----------|-------|--------|------------|-------|-------|--|
| | | A | B | C | T.L | W/PC | F | T.L | W/PC | T.L | W/PC | E | T.L | W/PC | H | I | G | W/PC | | |
| mm | in | mm | in | mm | mm | t | lbs | mm | t | lbs | t | lbs | mm | t | lbs | mm | mm | mm | lbs | |
| 6 | 1/4 | 100.00 | 4 | 78.00 | 11.00 | 1.00 | 2.21 | 10.00 | 0.10 | 0.26 | 0.04 | 0.25 | 9.00 | 0.04 | 0.25 | 80.00 | 50.00 | 5.30 | 11.69 | |
| 8 | 5/16 | 125.00 | 5 | 100.00 | 12.50 | 1.20 | 2.65 | 12.00 | 0.20 | 0.49 | 0.08 | 0.48 | 9.00 | 0.08 | 0.47 | 100.00 | 63.00 | 6.90 | 15.23 | |
| 9 | 3/8 | 150.00 | 6 | 120.00 | 12.50 | 1.50 | 3.31 | 16.00 | 0.50 | 0.66 | 0.15 | 0.65 | 11.00 | 0.15 | 0.64 | 130.00 | 75.00 | 8.30 | 18.31 | |
| 12 | 1/2 | 200.00 | 8 | 164.00 | 18.00 | 2.00 | 4.41 | 20.00 | 2.00 | 1.28 | 0.35 | 1.29 | 16.00 | 0.35 | 1.26 | 150.00 | 100.00 | 11.20 | 24.71 | |
| 16 | 5/8 | 250.00 | 10 | 202.00 | 21.50 | 3.00 | 6.62 | 22.00 | 3.00 | 2.36 | 0.70 | 2.32 | 19.00 | 0.70 | 2.27 | 180.00 | 125.00 | 14.20 | 31.33 | |
| 19 | 3/4 | 300.00 | 12 | 250.00 | 25.00 | 4.00 | 8.83 | 28.00 | 4.00 | 3.91 | 1.00 | 3.93 | 20.00 | 1.00 | 3.91 | 220.00 | 150.00 | 17.20 | 37.95 | |
| 22 | 7/8 | 325.00 | 13 | 269.00 | 28.00 | 5.00 | 11.03 | 33.00 | 5.00 | 5.63 | 1.50 | 5.69 | 21.00 | 1.50 | 5.74 | 250.00 | 165.00 | 20.30 | 44.79 | |
| 25 | 1 | 350.00 | 14 | 285.00 | 32.50 | 6.00 | 13.24 | 35.00 | 6.00 | 8.36 | 2.00 | 8.32 | 26.00 | 2.00 | 8.21 | 270.00 | 175.00 | 23.30 | 51.41 | |
| 32 | 1-1/4 | 400.00 | 16 | 310.00 | 45.00 | 8.00 | 17.65 | 36*70 | 10.00 | 16.77 | 3.00 | 16.59 | 34.00 | 3.00 | 16.42 | 300.00 | 200.00 | 29.00 | 63.99 | |
| 38 | 1-1/2 | 450.00 | 18 | 350.00 | 55.00 | 10.00 | 22.07 | 40*80 | 15.00 | 29.79 | 4.00 | 28.24 | 35.00 | 4.00 | 48.54 | 330.00 | 225.00 | 38.00 | 83.85 | |

DIN1480 TURNBUCKLE WITH HOOK & EYE

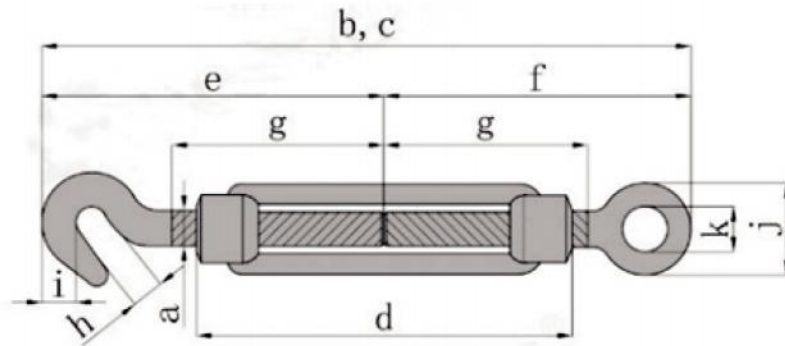

- STANDARD: DIN STANDARD
- MATERIAL: Q235 CARBON STEEL
- TECHNOLOGY: DROP FORGED
- SURFACE FINISH: ELECTO GALVANIZED

| Size(a) (mm) | Dimensions(mm) | | | | | | | | | | Weight(kg) |
|-----------------|----------------|-----|-----|-----|-----|-----|------|----|----|----|------------|
| | b | c | d | e | f | g | h | i | j | k | |
| 5 | 125 | 180 | 70 | 56 | 57 | 35 | 7 | 12 | 16 | 8 | 0.07 |
| 6 | 172 | 258 | 110 | 77 | 80 | 55 | 8 | 15 | 20 | 9 | 0.11 |
| 8 | 184 | 264 | 110 | 85 | 84 | 57 | 10.5 | 15 | 22 | 10 | 0.20 |
| 10 | 222 | 311 | 125 | 106 | 105 | 68 | 13 | 11 | 31 | 14 | 0.28 |
| 12 | 241 | 324 | 125 | 117 | 111 | 70 | 16 | 13 | 35 | 16 | 0.43 |
| 14 | 261 | 351 | 140 | 124 | 122 | 75 | 18 | 15 | 40 | 18 | 0.61 |
| 16 | 311 | 427 | 170 | 144 | 150 | 88 | 20 | 17 | 47 | 22 | 1.00 |
| 20 | 358 | 490 | 200 | 170 | 167 | 105 | 21 | 21 | 52 | 24 | 1.60 |
| 22 | 414 | 559 | 220 | 200 | 186 | 118 | 24 | 28 | 60 | 27 | 2.20 |
| 24 | 453 | 630 | 255 | 215 | 205 | 135 | 26 | 33 | 65 | 27 | 2.80 |
| 30 | 495 | 660 | 255 | 240 | 220 | 135 | 34 | 35 | 71 | 31 | 4.10 |
| 33 | 545 | 744 | 295 | 260 | 245 | 148 | 38 | 40 | 88 | 36 | 6.00 |
| 36 | 597 | 782 | 295 | 275 | 277 | 158 | 46 | 45 | 94 | 38 | 8.40 |

DIN1480 TURNBUCKLE WITH HOOK & HOOK

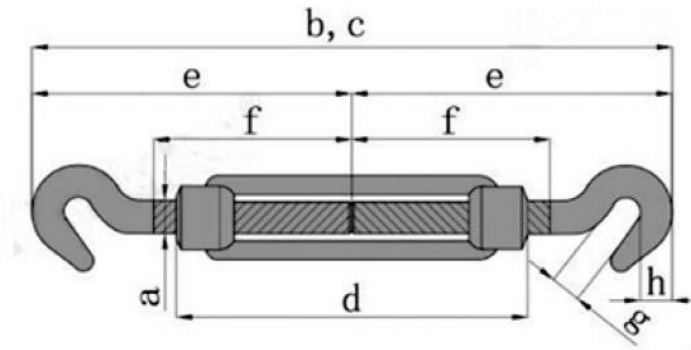

- STANDARD: DIN STANDARD
- MATERIAL: Q235 CARBON STEEL
- TECHNOLOGY: DROP FORGED
- SURFACE FINISH: ELECTO GALVANIZED

| Size(a) (mm) | Dimensions(mm) | | | | | | | Weight (kg) |
|-----------------|----------------|-----|-----|-----|-----|-------|----|----------------|
| | b | c | d | e | f | g | h | |
| 6 | 184 | 270 | 110 | 92 | 55 | 8.00 | 15 | 0.11 |
| 8 | 200 | 280 | 110 | 100 | 57 | 10.50 | 15 | 0.20 |
| 10 | 324 | 323 | 125 | 117 | 68 | 13.00 | 11 | 0.28 |
| 12 | 260 | 343 | 125 | 130 | 70 | 16.00 | 12 | 0.43 |
| 14 | 278 | 368 | 140 | 139 | 75 | 18.00 | 15 | 0.61 |
| 16 | 322 | 438 | 170 | 161 | 88 | 20.00 | 17 | 1.00 |
| 20 | 382 | 514 | 200 | 191 | 105 | 21.00 | 21 | 1.60 |
| 22 | 456 | 601 | 220 | 228 | 118 | 24.00 | 28 | 2.20 |
| 24 | 496 | 673 | 255 | 248 | 135 | 26.00 | 33 | 2.80 |
| 30 | 550 | 715 | 255 | 275 | 135 | 34.00 | 35 | 4.10 |
| 33 | 600 | 799 | 295 | 300 | 148 | 38.00 | 40 | 6.00 |
| 36 | 640 | 825 | 295 | 320 | 158 | 36.00 | 45 | 8.30 |

DIN1480 TURNBUCKLE WITH JAW & JAW

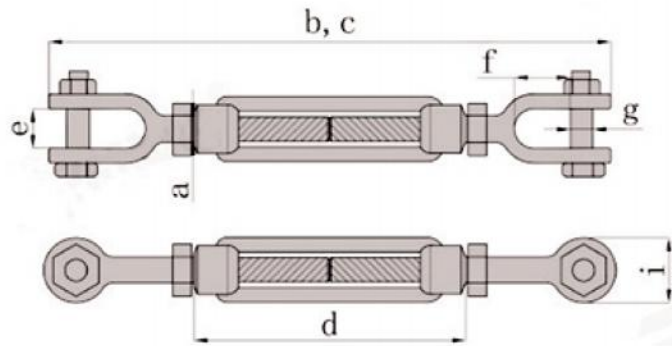

- STANDARD:DIN STANDARD
- MATERIAL:Q235 CARBON STEEL
- TECHNOLOGY:DROP FORGED
- SURFACE FINISH:ELECTO GALVANIZED

| Size(a) (mm) | Dimensions(mm) | | | | | | Weight (kg) |
|-----------------|----------------|-----|-----|-----|-----|-----|----------------|
| | b | c | d | e | f | g | |
| 6 | 240 | 326 | 110 | 86 | 120 | 65 | 0.093 |
| 8 | 240 | 320 | 110 | 80 | 120 | 65 | 0.14 |
| 10 | 300 | 389 | 125 | 89 | 150 | 75 | 0.29 |
| 12 | 300 | 383 | 125 | 83 | 150 | 75 | 0.40 |
| 14 | 330 | 420 | 140 | 90 | 165 | 85 | 0.66 |
| 16 | 400 | 516 | 170 | 116 | 200 | 100 | 0.89 |
| 20 | 440 | 572 | 200 | 132 | 220 | 120 | 1.60 |
| 22 | 440 | 585 | 220 | 145 | 220 | 130 | 2.27 |
| 24 | 520 | 697 | 255 | 177 | 260 | 150 | 2.82 |
| 30 | 520 | 695 | 255 | 165 | 260 | 160 | 4.23 |
| 36 | 600 | 780 | 295 | 185 | 300 | 180 | 7.10 |

DIN1480 TURNBUCKLE WITH EYE & EYE

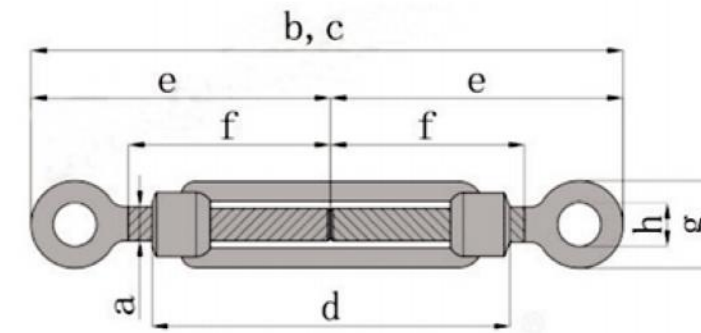

- STANDARD:DIN STANDARD
- MATERIAL:Q235 CARBON STEEL
- TECHNOLOGY:DROP FORGED
- SURFACE FINISH:ELECTO GALVANIZED

| Size(a) (mm) | Dimensions(mm) | | | | | | | Weight (kg) |
|-----------------|----------------|-----|-----|-----|-----|-----|----|----------------|
| | b | c | d | e | f | g | h | |
| 5 | 114 | 170 | 70 | 57 | 35 | 16 | 8 | 0.07 |
| 6 | 160 | 246 | 110 | 80 | 55 | 20 | 9 | 0.11 |
| 8 | 168 | 248 | 110 | 84 | 57 | 22 | 10 | 0.20 |
| 10 | 210 | 300 | 125 | 105 | 68 | 31 | 14 | 0.28 |
| 12 | 222 | 305 | 125 | 110 | 70 | 35 | 16 | 0.43 |
| 14 | 244 | 334 | 140 | 123 | 75 | 40 | 18 | 0.61 |
| 16 | 300 | 416 | 170 | 143 | 88 | 47 | 22 | 1.00 |
| 20 | 334 | 466 | 200 | 165 | 105 | 52 | 24 | 1.60 |
| 22 | 372 | 527 | 200 | 185 | 118 | 60 | 27 | 2.20 |
| 24 | 410 | 587 | 255 | 208 | 135 | 65 | 27 | 2.80 |
| 30 | 440 | 605 | 255 | 220 | 135 | 71 | 31 | 4.10 |
| 33 | 490 | 690 | 295 | 245 | 148 | 88 | 36 | 6.00 |
| 36 | 554 | 740 | 295 | 277 | 158 | 94 | 38 | 8.50 |
| 42 | 600 | 800 | 300 | 300 | 170 | 110 | 49 | 11.00 |

DIN1480 TURNBUCKLE STUB END

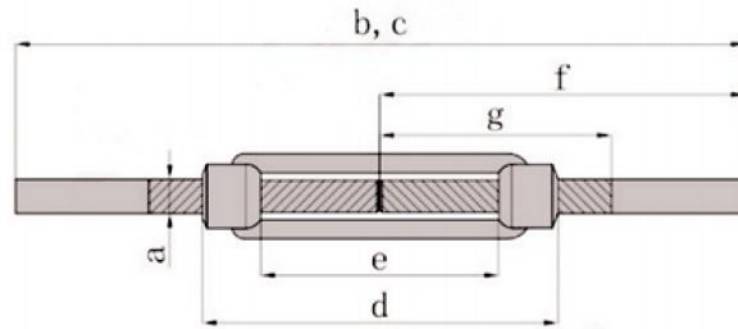

- STANDARD:DIN STANDARD
- MATERIAL:Q235 CARBON STEEL
- TECHNOLOGY:DROP FORGED
- SURFACE FINISH:ELECTO GALVANIZED

| Size(a) (mm) | Dimensions(mm) | | | | | | Weight (kg) |
|-----------------|----------------|-----|-----|-----|-----|-----|----------------|
| | b | c | d | e | f | g | |
| 6 | 240 | 326 | 110 | 86 | 120 | 65 | 0.093 |
| 8 | 240 | 320 | 110 | 80 | 120 | 65 | 0.14 |
| 10 | 300 | 389 | 125 | 89 | 150 | 75 | 0.29 |
| 12 | 300 | 383 | 125 | 83 | 150 | 75 | 0.40 |
| 14 | 330 | 420 | 140 | 90 | 165 | 85 | 0.66 |
| 16 | 400 | 516 | 170 | 116 | 200 | 100 | 0.89 |
| 20 | 440 | 572 | 200 | 132 | 220 | 120 | 1.60 |
| 22 | 440 | 585 | 220 | 145 | 220 | 130 | 2.27 |
| 24 | 520 | 697 | 255 | 177 | 260 | 150 | 2.82 |
| 30 | 520 | 695 | 255 | 165 | 260 | 160 | 4.23 |
| 36 | 600 | 780 | 295 | 185 | 300 | 180 | 7.10 |

DIN1480 TURNBUCKLE BODY ONLY

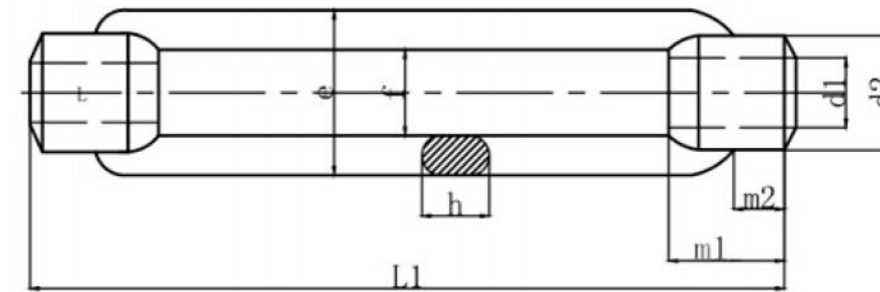

- STANDARD:DIN STANDARD
- MATERIAL:Q235 CARBON STEEL
- TECHNOLOGY:DROP FORGED
- SURFACE FINISH:ELECTO GALVANIZED

| Size (mm) | Dimensions(mm) | | | | | | | | Weight (kg) |
|--------------|----------------|------------|----|-----|----|----|----|----|----------------|
| | L1 | Adjustable | d2 | e | f | h | m1 | m2 | |
| M6 | 110 | 80 | 12 | 19 | 9 | 6 | 12 | 6 | 0.05 |
| M8 | 110 | 75 | 15 | 23 | 11 | 8 | 15 | 8 | 0.09 |
| M10 | 125 | 85 | 18 | 30 | 14 | 9 | 18 | 9 | 0.15 |
| M12 | 125 | 80 | 21 | 34 | 16 | 11 | 21 | 11 | 0.20 |
| M14 | 140 | 90 | 25 | 38 | 18 | 10 | 24 | 9 | 0.30 |
| M16 | 170 | 110 | 27 | 42 | 20 | 14 | 27 | 14 | 0.42 |
| M20 | 200 | 130 | 34 | 52 | 24 | 17 | 34 | 17 | 0.72 |
| M22 | 220 | 145 | 36 | 57 | 26 | 16 | 37 | 15 | 0.95 |
| M24 | 255 | 170 | 39 | 60 | 28 | 20 | 39 | 20 | 1.33 |
| M30 | 255 | 160 | 45 | 74 | 34 | 23 | 45 | 23 | 1.77 |
| M36 | 295 | 180 | 55 | 86 | 40 | 28 | 55 | 28 | 3.15 |
| M42 | 330 | 200 | 63 | 104 | 50 | 32 | 63 | 32 | 5.57 |
| M48 | 355 | 195 | 80 | 135 | 65 | 40 | 78 | 39 | 9.77 |
| M56 | 355 | 195 | 80 | 135 | 65 | 40 | 78 | 39 | 9.02 |

DIN1478 TURNBUCKLE

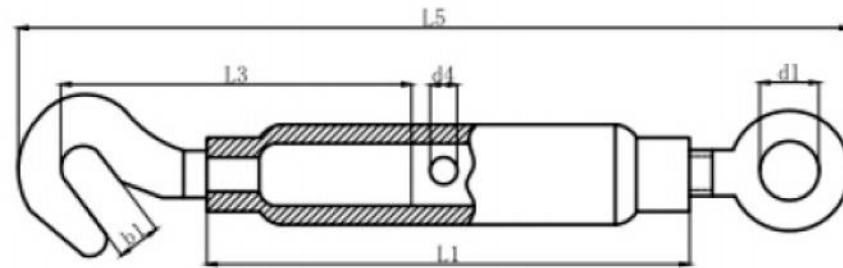

- STANDARD:DIN STANDARD
- MATERIAL:20# CARBON STEEL,Q235 CARBON STEEL
- TECHNOLOGY:TUBE-RETRACTED,THREAD ROD-DROP FORGED
- SURFACE FINISH:ELECTO GALVANIZED

| Size (mm) | Dimensions(mm) | | | | | | | Total Length Screwed in L5 | Weight 100pcs (lbs) |
|-----------|---------------------------|--------------------|----|--------|-------|--------|-------|----------------------------------|---------------------------|
| | Body Length L1 (mm) | Adjustable (mm) | d4 | Hook | | Eye | | | |
| | | | | L3 | b1 | L3 | d1 | | |
| M6 | 110 | 90 | 6 | 85.00 | 8.50 | 80.00 | 9.00 | 172.00 | 25.60 |
| M8 | 110 | 85 | 8 | 85.00 | 11.00 | 84.00 | 10.00 | 182.00 | 41.92 |
| M10 | 125 | 95 | 8 | 112.00 | 13.50 | 105.00 | 14.00 | 213.00 | 68.40 |
| M12 | 125 | 90 | 10 | 117.00 | 15.50 | 115.00 | 16.00 | 238.00 | 92.67 |
| M16 | 170 | 120 | 10 | 138.00 | 19.00 | 165.00 | 22.00 | 320.00 | 196.38 |
| M20 | 200 | 140 | 12 | 170.00 | 20.50 | 167.00 | 24.00 | 367.00 | 348.63 |
| M24 | 255 | 180 | 12 | 205.00 | 26.00 | 205.00 | 27.00 | 447.00 | 644.30 |
| M30 | 255 | 160 | 16 | 225.00 | 33.00 | 255.00 | 31.00 | 512.00 | 948.80 |
| M36 | 295 | 180 | 16 | 255.00 | 44.00 | 276.00 | 43.00 | 568.00 | 1334.95 |
| M42 | 330 | 200 | 20 | 340.00 | 48.00 | 260.00 | 49.00 | 683.00 | 2559.57 |
| M48 | 355 | 210 | 20 | 360.00 | 58.00 | 300.00 | 58.00 | 755.00 | 3530.45 |

AUSTRALIAN STANDARD CLOSED BODY TURNBUCKLE

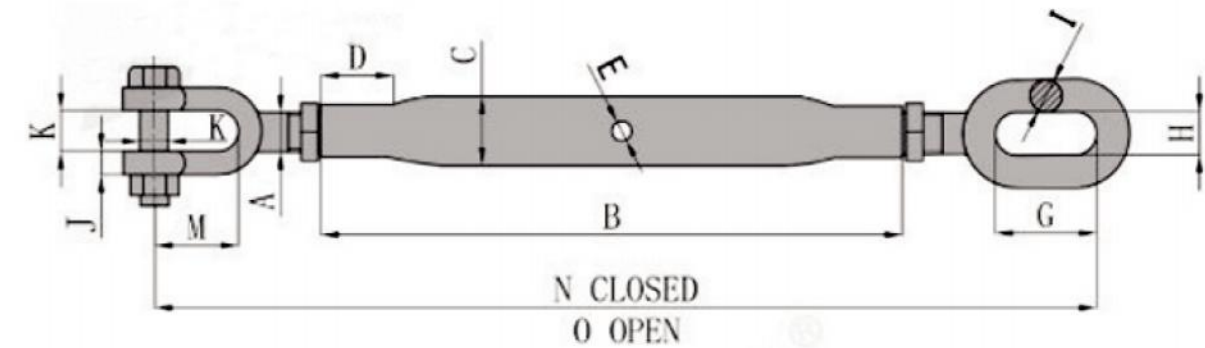

- STANDARD:AUSTRALIAN STANDARD
- MATERIAL:20# CARBON STEEL,#45 CARBON STEEL
- TECHNOLOGY:TUBE-RETRACTED,THREAD ROD-DROP FORGED
- SURFACE FINISH:ELECTO GALVANIZED

| Class | WLL (m.t) | Size | Dimensions(mm) | | | | | | | | | | | | | |
|---------|--------------|------|----------------|-----|----|----|----|----|----|----|-----|-----|-----|----|----|----|
| | | | A | B | C | D | E | J | K | L | M | N | O | G | H | I |
| Grade L | 0.30 | M10 | 10 | 152 | 21 | 16 | 8 | 8 | 11 | 8 | 21 | 235 | 349 | 25 | 11 | 8 |
| Grade L | 0.50 | M12 | 12 | 229 | 25 | 19 | 9 | 9 | 19 | 10 | 35 | 334 | 527 | 36 | 14 | 11 |
| Grade L | 0.75 | M16 | 16 | 229 | 27 | 22 | 11 | 9 | 22 | 12 | 51 | 375 | 556 | 40 | 18 | 14 |
| Grade L | 1.25 | M20 | 20 | 229 | 34 | 28 | 11 | 11 | 22 | 16 | 48 | 385 | 554 | 55 | 25 | 17 |
| Grade L | 2.50 | M24 | 24 | 356 | 42 | 32 | 13 | 14 | 32 | 22 | 65 | 528 | 812 | 57 | 26 | 20 |
| Grade L | 3.00 | M27 | 27 | 356 | 45 | 41 | 13 | 14 | 32 | 22 | 65 | 542 | 817 | 57 | 26 | 20 |
| Grade L | 5.00 | M33 | 33 | 381 | 51 | 41 | 14 | 19 | 38 | 24 | 76 | 602 | 884 | 64 | 34 | 25 |
| Grade L | 6.00 | M39 | 39 | 407 | 57 | 44 | 16 | 20 | 47 | 32 | 90 | 644 | 934 | 75 | 38 | 27 |
| Grade L | 7.00 | M45 | 45 | 407 | 70 | 51 | 17 | 25 | 51 | 36 | 111 | 670 | 942 | 85 | 40 | 30 |
| Grade P | 0.60 | M10 | 10 | 152 | 21 | 16 | 8 | 8 | 11 | 8 | 21 | 235 | 349 | 25 | 11 | 8 |
| Grade P | 1.00 | M12 | 12 | 229 | 25 | 19 | 9 | 9 | 19 | 10 | 35 | 334 | 527 | 36 | 14 | 11 |
| Grade P | 1.60 | M16 | 16 | 229 | 27 | 22 | 11 | 9 | 22 | 12 | 51 | 375 | 556 | 40 | 18 | 14 |
| Grade P | 2.50 | M20 | 20 | 229 | 34 | 28 | 11 | 11 | 22 | 16 | 48 | 385 | 554 | 55 | 25 | 17 |
| Grade P | 4.00 | M24 | 24 | 356 | 42 | 32 | 13 | 14 | 32 | 22 | 65 | 528 | 812 | 57 | 26 | 20 |
| Grade P | 5.00 | M27 | 27 | 356 | 45 | 41 | 13 | 14 | 32 | 22 | 65 | 542 | 817 | 57 | 26 | 20 |
| Grade P | 8.00 | M33 | 33 | 381 | 51 | 41 | 14 | 19 | 38 | 24 | 76 | 602 | 884 | 64 | 34 | 25 |
| Grade P | 10.00 | M39 | 39 | 407 | 57 | 44 | 16 | 20 | 47 | 32 | 90 | 644 | 934 | 75 | 38 | 27 |
| Grade P | 12.00 | M45 | 45 | 407 | 70 | 51 | 17 | 25 | 51 | 36 | 111 | 670 | 942 | 85 | 40 | 30 |
| Grade S | 0.80 | M10 | 10 | 152 | 21 | 16 | 8 | 8 | 11 | 8 | 21 | 235 | 349 | 25 | 11 | 8 |
| Grade S | 1.20 | M12 | 12 | 229 | 25 | 19 | 9 | 9 | 19 | 10 | 35 | 334 | 527 | 36 | 14 | 11 |
| Grade S | 2.00 | M16 | 16 | 229 | 27 | 22 | 11 | 9 | 22 | 12 | 51 | 375 | 556 | 40 | 18 | 14 |
| Grade S | 3.20 | M20 | 20 | 229 | 34 | 28 | 11 | 11 | 22 | 16 | 48 | 385 | 554 | 55 | 25 | 17 |
| Grade S | 5.00 | M24 | 24 | 356 | 42 | 32 | 13 | 14 | 32 | 22 | 65 | 528 | 812 | 57 | 26 | 20 |
| Grade S | 6.30 | M27 | 27 | 356 | 45 | 41 | 13 | 14 | 32 | 22 | 65 | 542 | 817 | 57 | 26 | 20 |
| Grade S | 10.00 | M33 | 33 | 381 | 51 | 41 | 14 | 19 | 38 | 24 | 76 | 602 | 884 | 64 | 34 | 25 |
| Grade S | 12.00 | M39 | 39 | 407 | 57 | 44 | 16 | 20 | 47 | 32 | 90 | 644 | 934 | 75 | 38 | 27 |
| Grade S | 16.00 | M45 | 45 | 407 | 70 | 51 | 17 | 25 | 51 | 36 | 111 | 670 | 942 | 85 | 40 | 30 |